

I:\CITYPPS\AUTOCAD\STD_DETAILS\DRAWING_FILES\T10-24A

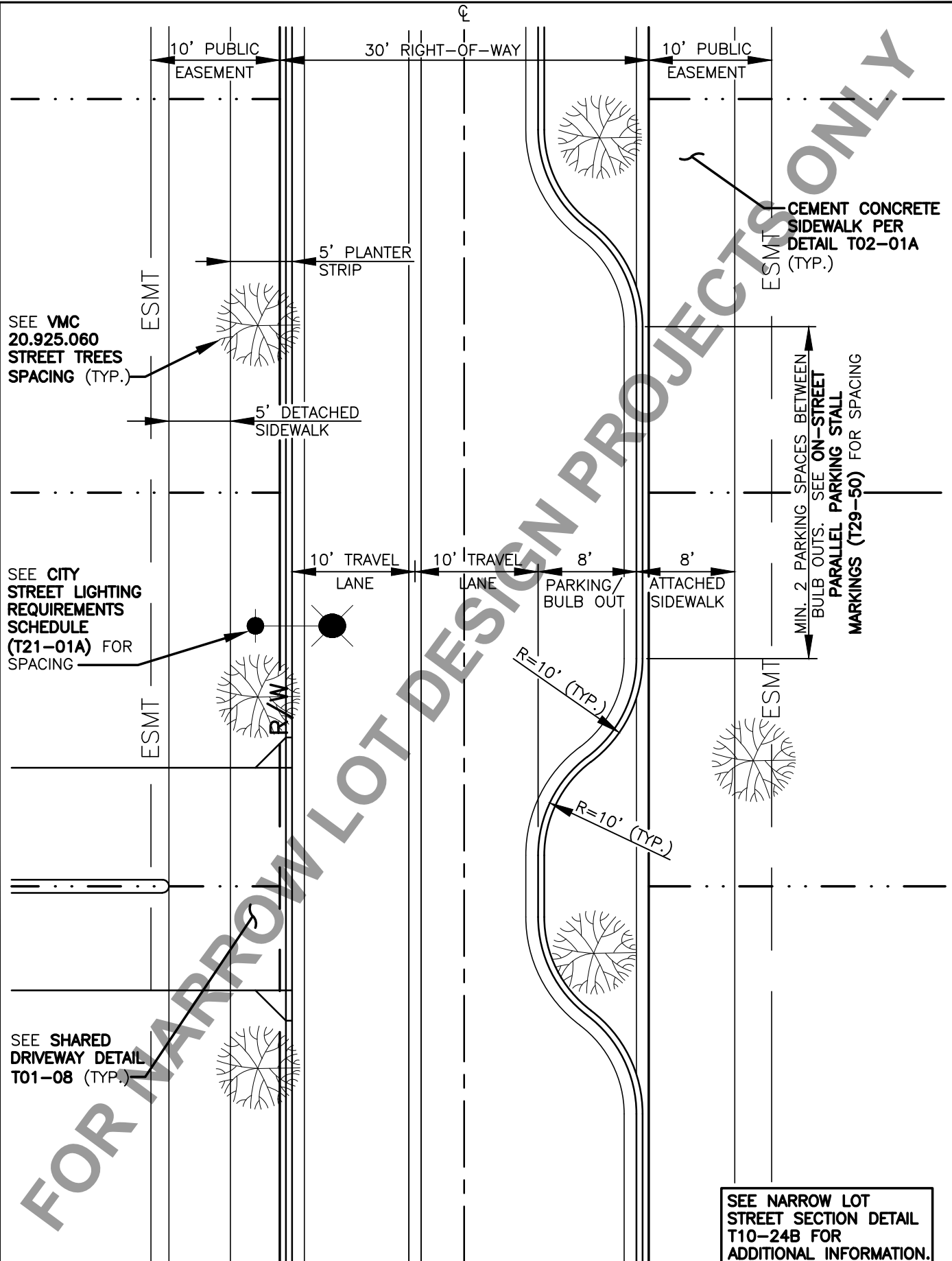

SEE VMC
20.925.060
STREET TREES
SPACING (TYP.)

SEE CITY
STREET LIGHTING
REQUIREMENTS
SCHEDULE
(T21-01A) FOR
SPACING

SEE SHARED
DRIVEWAY DETAIL
T01-08 (TYP.)

SEE NARROW LOT
STREET SECTION DETAIL
T10-24B FOR
ADDITIONAL INFORMATION.

REV. NO.	DATE	BY	APPR
1	2/07	RAW	MHA
2	8/08	RAW	MHA
3	7/14	RAW	MHA
4	9/21	RAW	MHA

PUBLIC WORKS - STREETS
AND TRANSPORTATION

APPROVED BY: *M.H. Sedalla*
ENGINEER MANAGER

APPROVED DATE: 9/1/2021



NARROW LOT STREET
PLAN DETAIL

STANDARD PLAN
NUMBER
T10-24A