

24"
NO
PARKING
 30"
 R8-3
 R/W

INSTALL ON TYPE 2 BARRICADES THROUGHOUT THE WORK AREA 24 HOURS PRIOR TO IMPLEMENTING TRAFFIC CONTROL. PRIOR NOTIFICATION OF LOCAL LAW ENFORCEMENT REQUIRED.

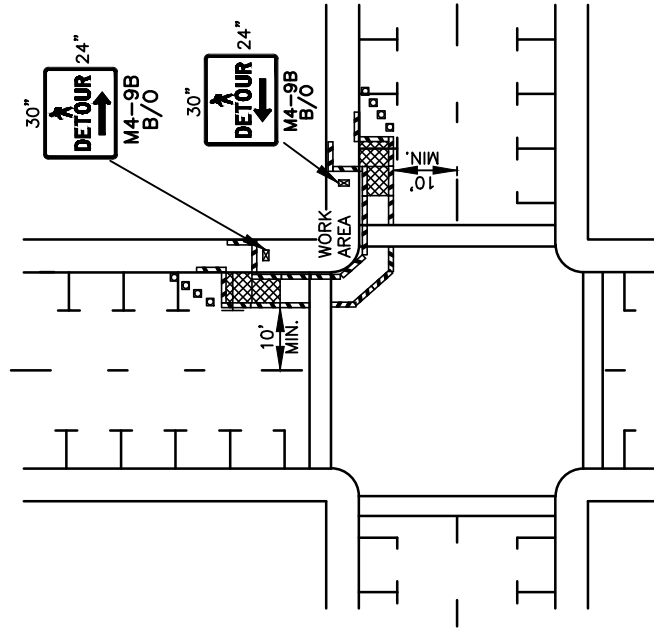

SIDEWALK DIVERSION

- LEGEND**
- TEMPORARY SIGN LOCATION
 - CHANNELIZING DEVICES
 - ▭ PEDESTRIAN CHANNELIZING DEVICES
 - ▨ TEMPORARY PEDESTRIAN RAMP FOR SIDEWALKS

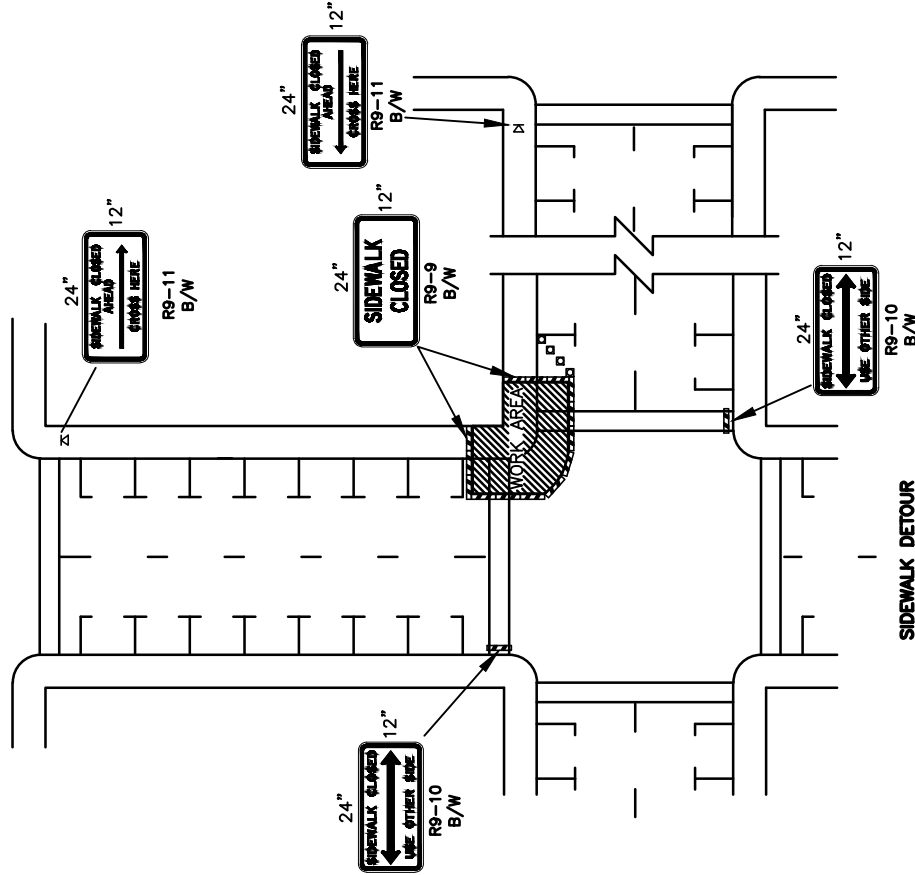

SIDEWALK DETOUR

NOTES

1. CONTROLS SHOWN ARE FOR PEDESTRIAN TRAFFIC ONLY.
2. A 60" PATH WIDTH SHOULD BE MAINTAINED (48" IS THE MINIMUM).
3. CONTACT AND COORDINATE IMPACTED TRANSIT AGENCIES PRIOR TO IMPLEMENTING ANY CLOSURES.
4. SEE SHEET TC-52 OR TC-53 FOR TEMPORARY PEDESTRIAN RAMP DETAILS.
5. ADA PEDESTRIAN FACILITIES MUST BE MAINTAINED. SEE STANDARD SPECIFICATION 1-10.2(1)B.
6. TEMPORARY PEDESTRIAN PUSH BUTTONS SHALL BE PLACED ON THE DIVERTED PATH WHEN EXISTING BUTTONS ARE NOT ACCESSIBLE TO PEDESTRIANS.

REV. NO.	DATE	BY	APPROVED
1	9/21	RAW	CJC

PUBLIC WORKS - STREETS AND TRANSPORTATION

APPROVED BY: *[Signature]*
 TRAFFIC ENGINEER MANAGER
 9/1/2021

APPROVED DATE:



TRAFFIC CONTROL STANDARD PLAN
 INTERSECTION PEDESTRIAN
 TRAFFIC CONTROL

STANDARD PLAN NUMBER

TC16A