

BUFFER DATA					
LONGITUDINAL BUFFER SPACE = B	25	30	35	40	45
SPEED (MPH)	25	30	35	40	45
LENGTH (FEET)	155	200	250	305	360
BUFFER VEHICLE ROLL AHEAD DISTANCE = R					
TRANSPORTABLE ATTENUATOR	30 FEET				
MINIMUM HOST VEHICLE WEIGHT	15,000 LBS. THE MAXIMUM WEIGHT SHALL BE IN ACCORDANCE WITH THE MANUFACTURERS RECOMMENDATION.				
PROTECTIVE VEHICLE	NO SPECIFIED DISTANCE REQUIRED				
MAY BE A WORK VEHICLE STRATEGICALLY LOCATED TO SHIELD THE WORK AREA.					

SIGN SPACING = X (1)				
PRINCIPAL ARTERIALS	45 MPH	500'±		
PRINCIPAL, MINOR OR COLLECTOR ARTERIALS	35/40 MPH	350'±		
PRINCIPAL, MINOR, COLLECTOR ARTERIALS, INDUSTRIAL AND LOCAL ACCESS ROADWAYS	25/30 MPH	200'± (2)		
INDUSTRIAL AND LOCAL ACCESS ROADWAYS	25 MPH OR LESS	100'± (2)		
(1) ALL SPACING MAY BE ADJUSTED TO ACCOMMODATE INTERSECTIONS AND DRIVEWAYS.				
(2) THIS SPACING MAY BE REDUCED IN URBAN AREAS TO FIT ROADWAY CONDITIONS.				

MINIMUM LANE CLOSURE TAPER LENGTH = L (FEET)				
LANE WIDTH (FEET)	POSTED SPEED (MPH)			
		25	30	35
10	105	150	205	270
11	115	165	225	295
12	125	180	245	320
13	135	195	265	345

MINIMUM SHOULDER TAPER LENGTH = L/3 (FEET)				
SHOULDER WIDTH (FEET)	POSTED SPEED (MPH)			
		25	30	35
8	40	40	60	90
10	40	60	90	150

USE A MINIMUM 3 DEVICES TAPER FOR SHOULDER LESS THEN 8'.

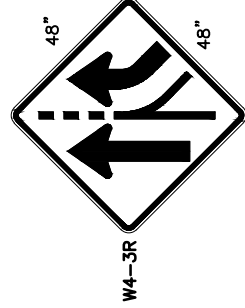

PCMS	
1	2
RIGHT LANE CLOSURE	
2.0 SEC	2.0 SEC

CHANNELIZATION DEVICE SPACING (FEET)		
MPH	TAPER	TANGENT
35/45	30	60
25/30	20	40

FIELD LOCATE 1 MILE ± IN ADVANCE OF LANE CLOSURE SIGNING.

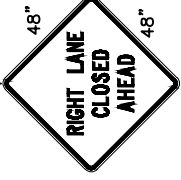
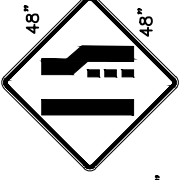
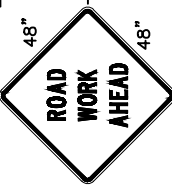
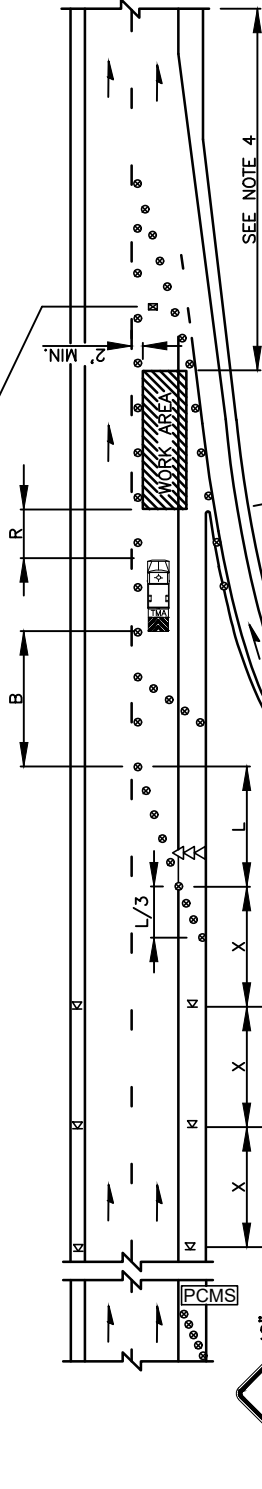

- NOTES:
- SEE SPECIAL PROVISIONS FOR CLOSURE HOUR RESTRICTIONS.
 - DEVICES SHALL NOT ENCR OACH INTO ADJACENT LANES.
 - USE TRANSVERSE DEVICES IN CLOSED LANES EVERY 1000'± (RECOMMENDED).
 - SEE SHEET TCXX FOR A SHORT TERM ON-RAMP CLOSURE WHEN THE WORK AREA LOCATION RESTRICTS RAMP ACCESS.
 - ALL SIGNS ARE BLACK ON ORANGE.

- LEGEND
- K TEMPORARY SIGN LOCATION
 - ⊗ TRAFFIC SAFETY DRUM
 - ▷▷▷ SEQUENTIAL ARROW SIGN
 - TRANSPORTABLE ATTENUATOR
 - PCMS PORTABLE CHANGEABLE MESSAGE SIGN
 - ⊗ TEMPORARY SIGN LOCATION (5' MOUNTING HEIGHT)

REV	NO.	DATE	BY	APP'D	REASON
1	5/16	RAW	CJC		
2	9/21	RAW	CJC		

APPROVED BY: *[Signature]* TRAFFIC ENGINEER MANAGER
APPROVED DATE: 9/1/2021

CITY OF **Vancouver** WASHINGTON

TRAFFIC CONTROL STANDARD PLAN
TEMPORARY ON-RAMP FOR
MULTI-LANE ROADWAYS

STANDARD PLAN NUMBER
TC8