

**GENERAL NOTES:**

1. BUILDING FOOTPRINTS ARE ILLUSTRATIVE AND SUBJECT TO CHANGE.
2. OPEN SPACE BOUNDARIES ARE CONCEPTUAL. THE LOCATIONS AND SIZE OF EACH OPEN SPACE AREA WILL BE REFINED AT THE SITE DEVELOPMENT STAGE.

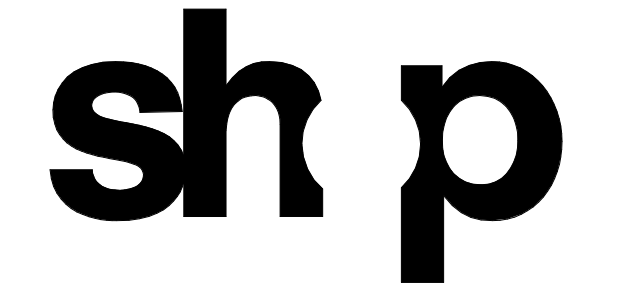
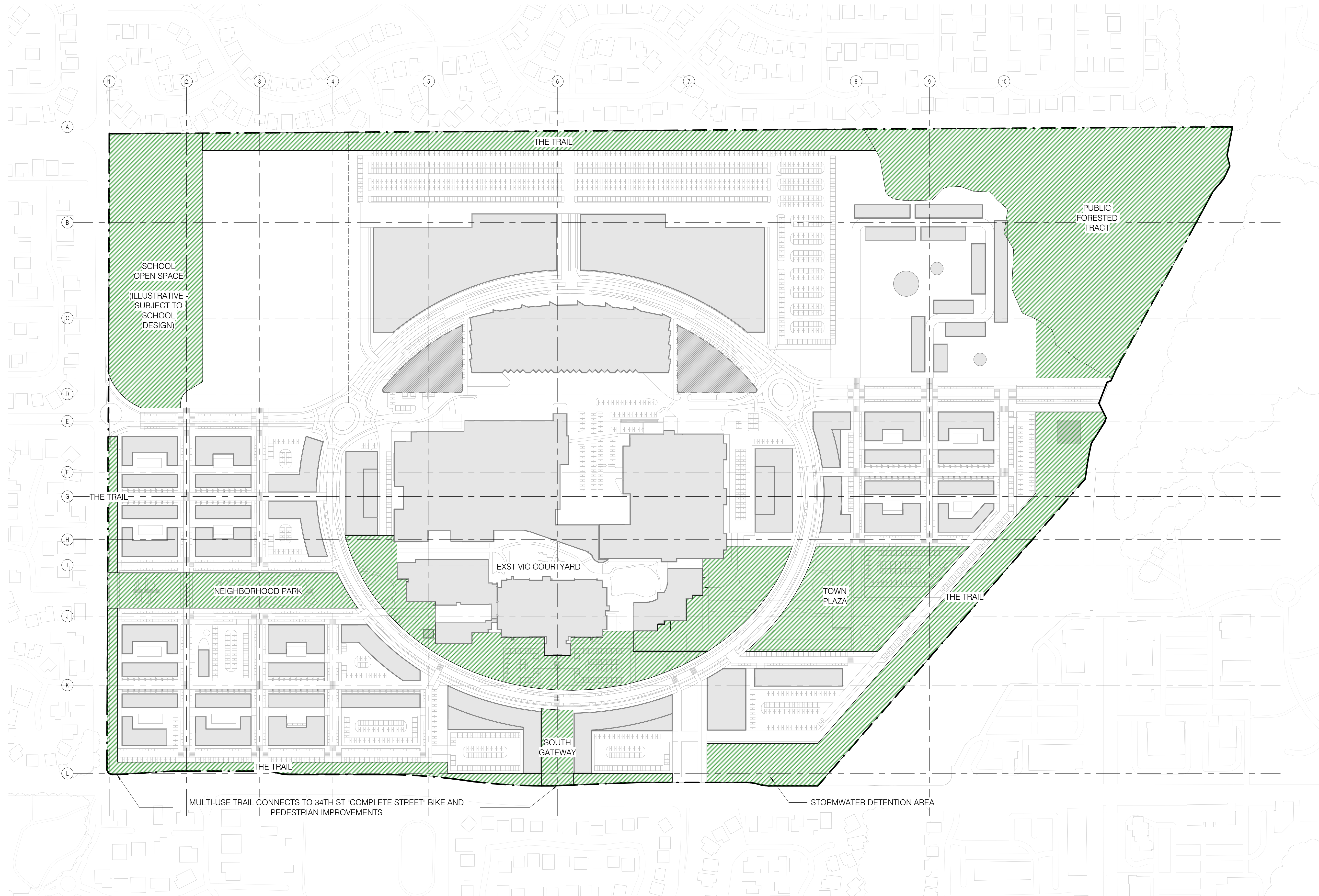

<b>CLIENT</b> RABINA 505 FIFTH AVENUE, 27TH FLOOR NEW YORK, NY 10017 tel 212.680.4500	<b>CLIENT</b> NEW BLUEPRINT PARTNERS 44 S. BROADWAY WHITE PLAINS, NY 10601
<b>URBAN DESIGN + MASTERPLAN ARCHITECT</b> ShoP ARCHITECTS 233 BROADWAY 11TH FLOOR NEW YORK, NY 10029 tel 212.889.9005	<b>MASTERPLAN LOCAL ARCHITECT</b> EL DORADO ARCHITECTS 1633 NW MARSHAL STREET PORTLAND, OR 97209 tel 971.266.8665
<b>LANDSCAPE ARCHITECT</b> SITEWORKSHOP 3800 WOODLAND PARK AVE. N, SUITE 200 SEATTLE, WA 98103 tel 206.285.3026	<b>CIVIL ENGINEER</b> KPF 111 SW 5TH AVENUE #2900 PORTLAND, OR 97204 tel 503.227.3251
<b>TRAFFIC ENGINEER</b> KITTELSON & ASSOCIATES 651 SW 6TH AVE., SUITE 600 PORTLAND, OR 97204 tel 800.878.5290	<b>LAND USE CONSULTANT</b> DOWL 720 SW WASHINGTON ST., SUITE 750 PORTLAND, OR 97205 tel 971.280.8641
<b>ENERGY &amp; WATER USE DISTRICT PLANNING</b> PAE ENGINEERS 151 SW 15TH AVENUE PORTLAND, OR 97204 tel 503.226.2921	<b>SUSTAINABILITY</b> PAE ENGINEERS 151 SW 15TH AVENUE PORTLAND, OR 97204 tel 503.226.2921

**VANCOUVER INNOVATION CENTER**

**URBAN DESIGN / MASTERPLAN**

VANCOUVER, WA.

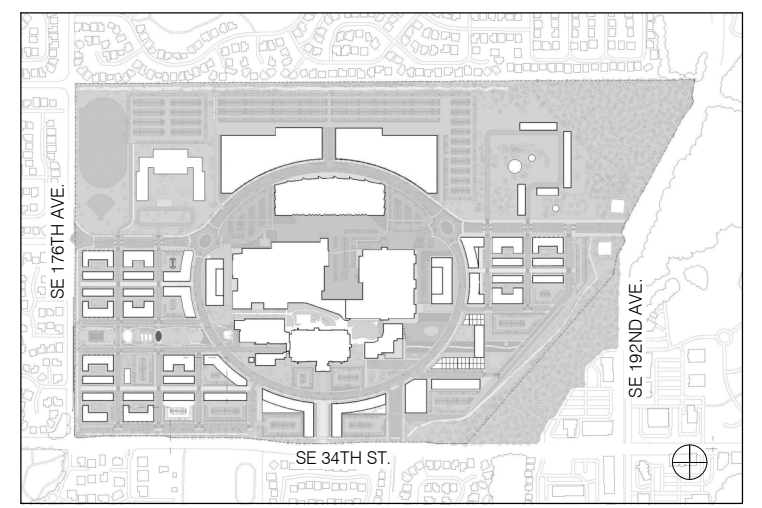

NO.	DATE	REVISION

THESE DRAWINGS ARE INSTRUMENTS OF SERVICE AND AS SUCH MAY NOT BE USED FOR OTHER PROJECTS, FOR ADDITIONS TO THIS PROJECT OR COMPLETION OF THIS PROJECT BY OTHERS.  
COPYRIGHT © 2023 SHO P ARCHITECTS PC. ALL RIGHTS RESERVED.

● NOT FOR CONSTRUCTION

SHEET INFORMATION: ARCH D 24'X36'

**DRAWING TITLE**  
**SITE PLAN - POTENTIAL OPEN SPACE**

<b>SEAL &amp; SIGNATURE</b>	<b>DATE</b>
<b>DRAWN BY</b>	<b>PROJECT NO.</b>
Author	210917
<b>CHECKED BY</b>	<b>DATE</b>
Checker	

**DRAWING NUMBER**  
**004**