

**GENERAL NOTES:**

1. LOCATION OF STREET TYPES 04 LOCAL ACCESS CONNECTIONS AND 05 PEDESTRIAN LANEWAYS ARE ILLUSTRATIVE AND SUBJECT TO CHANGE.
2. BUILDING FOOTPRINTS ARE ILLUSTRATIVE AND SUBJECT TO CHANGE.
3. REFER TO SHEET 009 FOR CORRESPONDING STREET SECTIONS.

**MOBILITY LEGEND**

- STREET TYPE 01 - MAIN STREET ALONG LOOP
- STREET TYPE 02 - SLOW STREET ALONG LOOP
- STREET TYPE 03 - LOCAL STREET/NEIGHBORHOOD LOOP
- STREET TYPE 04 - LOCAL ACCESS CONNECTIONS
- STREET TYPE 05 - PEDESTRIAN LANEWAYS
- STREET TYPE 06 - SOUTH ACCESS BOULEVARD
- - - ROUNDABOUT - 15,393 GSF EACH
- SURFACE PARKING LOT
- TRAIL - REFER TO SHEET 010
- STREET TYPE "S" - SCHOOL ACCESS - SECTION TBD PER SCHOOL DISTRICT DESIGN

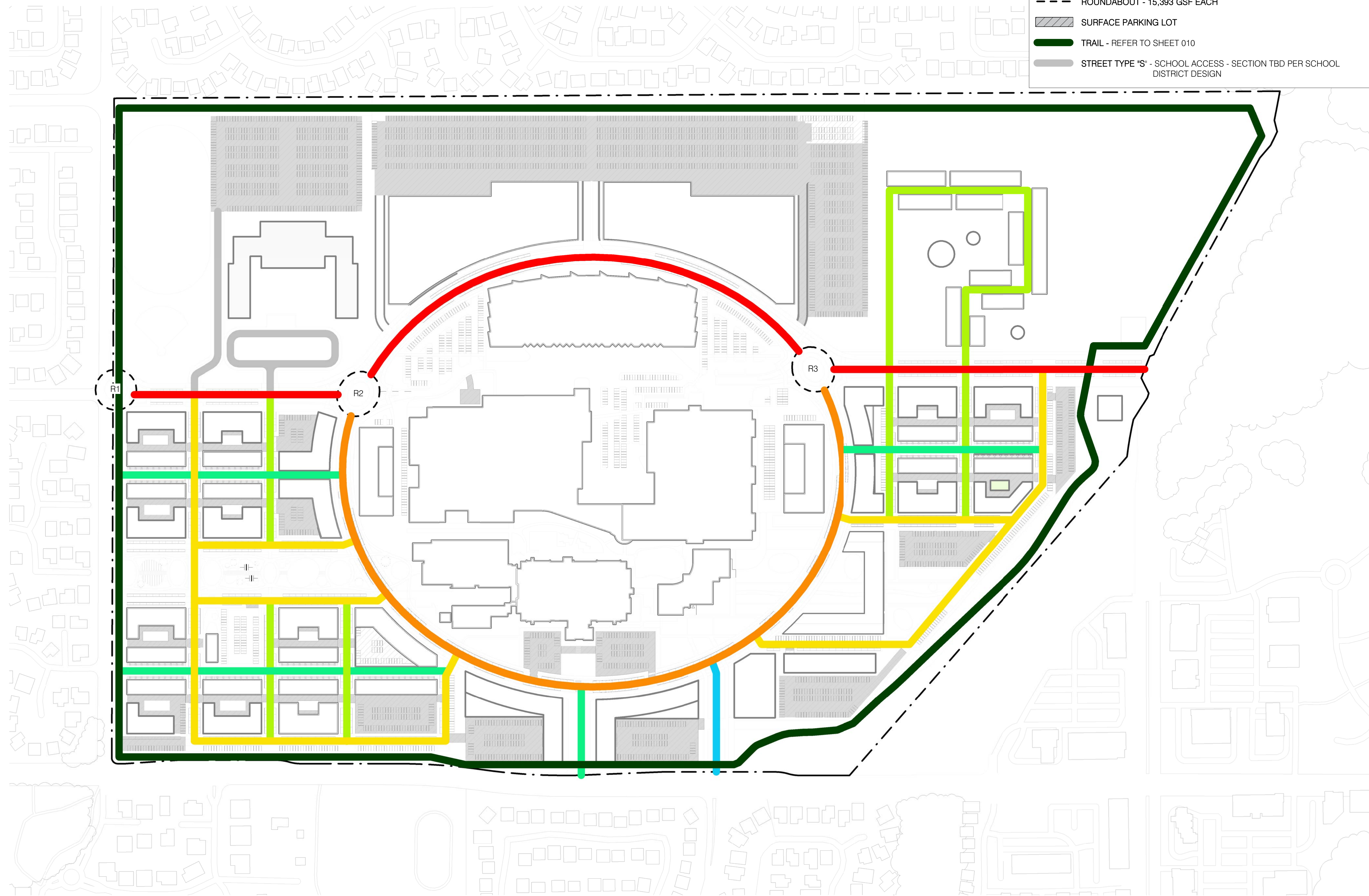

<b>CLIENT</b> RABINA 505 FIFTH AVENUE, 27TH FLOOR NEW YORK, NY 10017 tel 212.680.4500	<b>CLIENT</b> NEW BLUEPRINT PARTNERS 44 S. BROADWAY WHITE PLAINS, NY 10601
<b>URBAN DESIGN + MASTERPLAN ARCHITECT</b> SHOP ARCHITECTS 225 BROADWAY 11TH FLOOR NEW YORK, NY 10028 tel 212.889.9005	<b>MASTERPLAN LOCAL ARCHITECT</b> EL DORADO ARCHITECTS 1623 NW MARSHAL STREET PORTLAND, OR 97209 tel 971.266.8665
<b>LANDSCAPE ARCHITECT</b> SITELABORATORY 3800 WOODLAND PARK AVE, N. SUITE 200 SEATTLE, WA 98103 tel 206.285.3028	<b>CIVIL ENGINEER</b> KPF 111 SW 5TH AVENUE, #2500 PORTLAND, OR 97204 tel 503.227.3251
<b>TRAFFIC ENGINEER</b> KITTELSON & ASSOCIATES 851 SW 6TH AVE, SUITE 600 PORTLAND, OR 97204 tel 850.679.5230	<b>LAND USE CONSULTANT</b> DOWL 720 SW WASHINGTON ST., SUITE 750 PORTLAND, OR 97205 tel 971.280.8641
<b>ENERGY &amp; WATER USE DISTRICT PLANNING</b> PAE ENGINEERS 151 SW 1ST AVENUE PORTLAND, OR 97204 tel 503.226.2921	<b>SUSTAINABILITY</b> PAE ENGINEERS 151 SW 1ST AVENUE PORTLAND, OR 97204 tel 503.226.2921

**VANCOUVER INNOVATION CENTER**  
**URBAN DESIGN / MASTERPLAN**

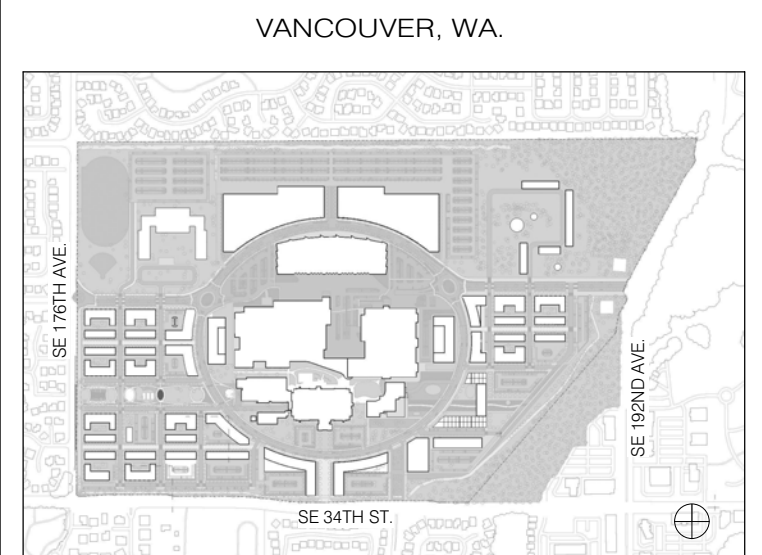

NO.	DATE	REVISION
3	8/25/2022	PRE-APPLICATION DESIGN PACKAGE

THESE DRAWINGS ARE INSTRUMENTS OF SERVICE AND AS SUCH MAY NOT BE USED FOR OTHER PROJECTS, FOR ADDITIONS TO THIS PROJECT OR COMPLETION OF THIS PROJECT BY OTHERS.

COPYRIGHT © 2022 SHoP ARCHITECTS PC. ALL RIGHTS RESERVED.

**NOT FOR CONSTRUCTION**

SHEET INFORMATION: ARCH D 24"x36"

**DRAWING TITLE**  
**SITE PLAN - MOBILITY PLAN**

<b>SEAL &amp; SIGNATURE</b>	<b>DATE</b>	08/11/2022
<b>PROJECT NO.</b>	210917	
<b>DRAWN BY</b>	Author	
<b>CHECKED BY</b>	Checker	

**DRAWING NUMBER**