

	MINIMUM DISTANCE
A	5 FEET
B	10 FEET
C	30 FEET
W	DRIVEWAY WIDTH

**NON-ARTERIAL STREETS – RESIDENTIAL POLICY
REGULATIONS FOR CURB OPENING AND DRIVEWAYS**

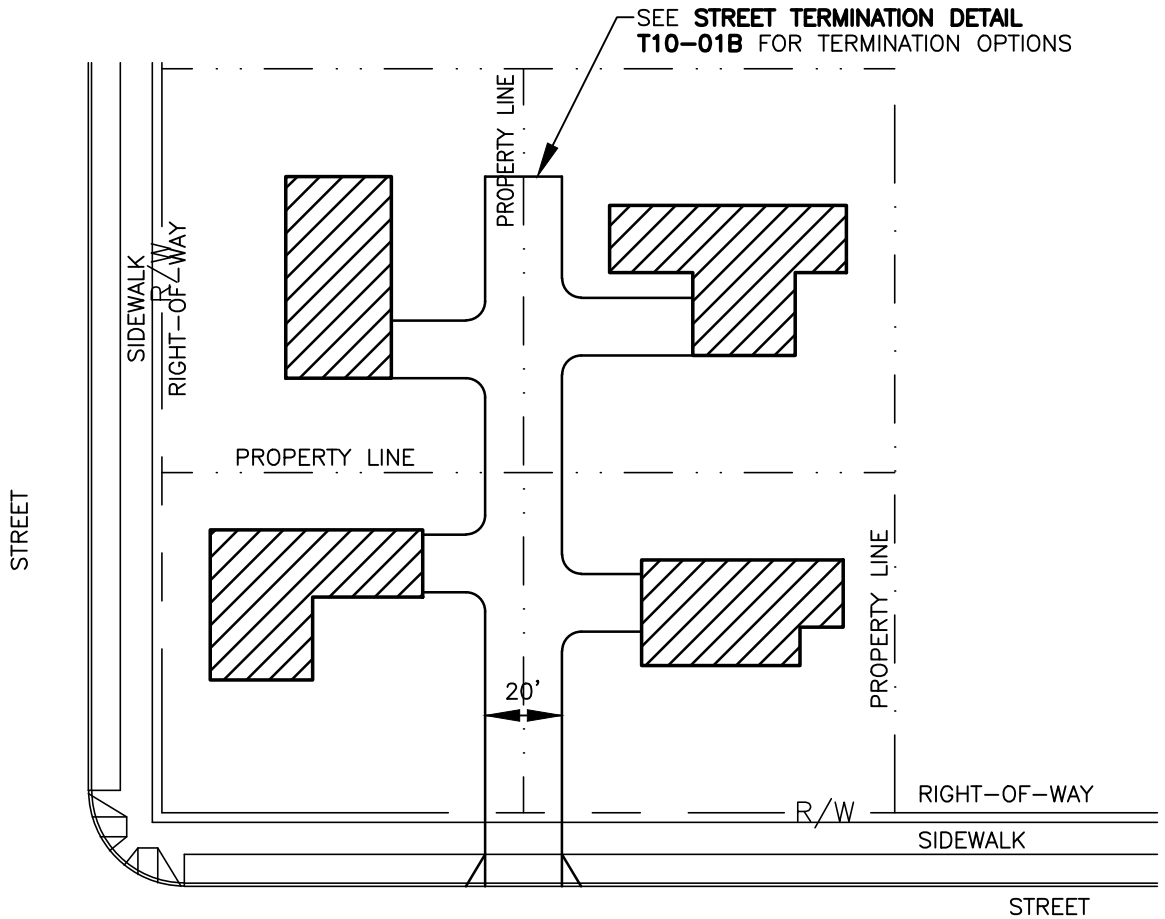

**NON-ARTERIAL STREETS – RESIDENTIAL POLICY
FLAG-STEM AND SHARED DRIVEWAYS**

NON-ARTERIAL STREET DRIVEWAY POLICY



CITY OF VANCOUVER
DEPARTMENT OF PUBLIC WORKS
TRANSPORTATION DIVISION

DRAWN BY	APPROVED BY	APPROVAL DATE
CDC	<i>MATT</i>	8/04
REVISION	APPROVED BY	APPROVAL DATE
7	<i>MATT</i>	3/24

STD. PLAN NO.
T04-12