

1/4" TOOLED RADIUS
ALL EXPOSED EDGES

2.0'

ANTI-SKATEBOARDING
STUDS - 24" SPACING
(18" FROM BENCH ENDS)

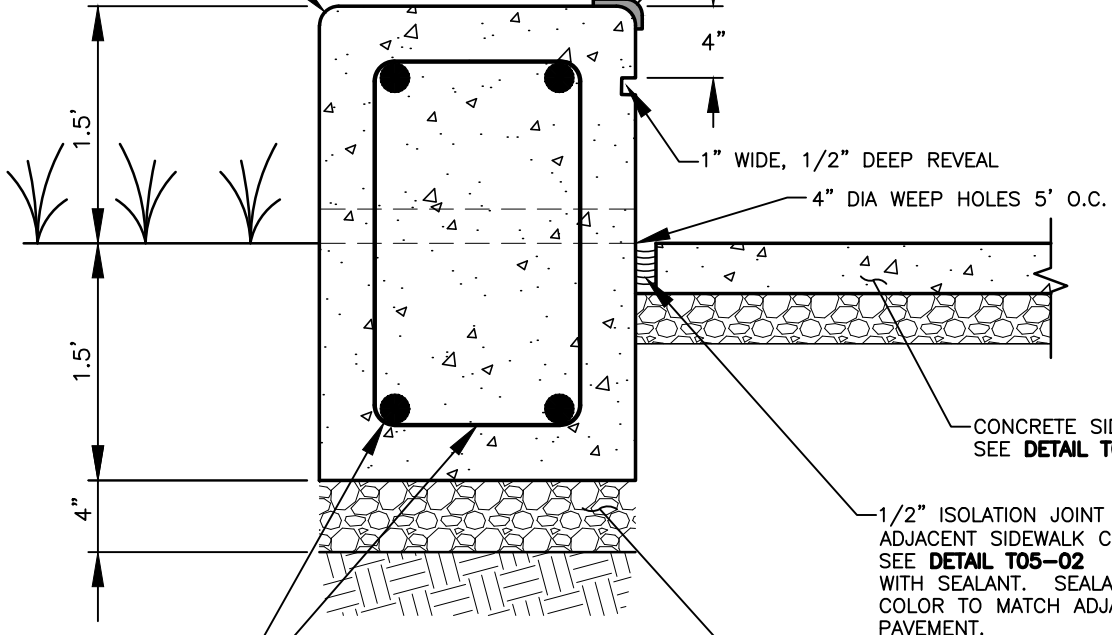

CONCRETE SIDEWALK
SEE **DETAIL T02-01A**

1/2" ISOLATION JOINT MATCH
ADJACENT SIDEWALK COLOR
SEE **DETAIL T05-02**
WITH SEALANT. SEALANT
COLOR TO MATCH ADJACENT
PAVEMENT.

4" MIN. CRUSHED
SURFACING TOP COURSE

#4 REBAR IN ALL
DIRECTIONS TIE AT
CORNERS 2" CLEAR
FROM EXPOSED FACES

NOTES:

1. ANTI-SKATEBOARDING DEVICES TO BE INSTALLED ON BOTH TOP EDGES OF SEAT WALL WITH 2' SPACING.
2. SACK, PATCH, AND RUB SMOOTH ALL EXPOSED SURFACES.

**HEIGHTS DISTRICT REDEVELOPMENT
CONCRETE SEAT WALL**



CITY OF VANCOUVER
DEPARTMENT OF PUBLIC WORKS
TRANSPORTATION DIVISION

DRAWN BY	APPROVED BY	APPROVAL DATE
CDC	<i>MATT</i>	9/21
REVISION	APPROVED BY	APPROVAL DATE
2	<i>MATT</i>	3/24

STD. PLAN NO.
T08-29