

DIMENSIONS:

WIDTH (INCHES)	0.95
HEIGHT (INCHES)	2.19
SIZE (HEX) OR SIZE (BOLT)	3/8
SIZE (HEX) OR SIZE (BOLT)	0.38
B LENGTH (INCHES)	0.63

GENERAL:

PRODUCT DESCRIPTION
 MECHANICAL GROUND ROD CLAMP
 FOR CABLE TO ROD, HIGH STRENGTH,
 10 AWG (SOL) – 1 AWG (STR), 5/8”
 DRIVE ROD, 3/8” STUD.

CONDUCTORS:

ROD SIZE (RANGE)	5/8 INCH
COPPER STRANDED (RANGE)	12 AWG – 1 AWG

PHYSICAL:

PRODUCT MATERIAL: COPPER

APPROVALS/CERTIFICATIONS:

RATED FOR DIRECT BURIAL	Y
UL LISTED	Y
CSA CERTIFIED	Y
ROHS COMPATIBLE	COMPLIANT
UL RECOGNIZED	N
CULUS	N
INDUSTRY STANDARDS	RUS

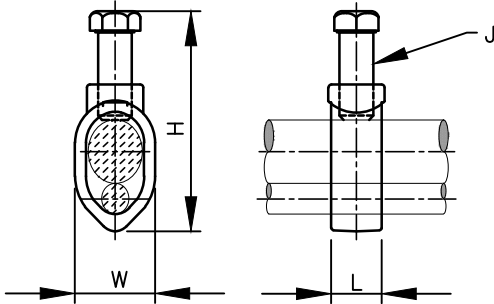

5/8 INCH GROUND ROD CLAMP

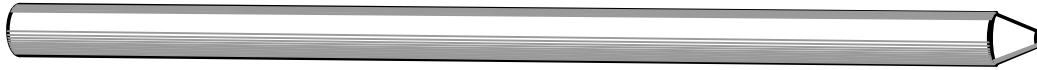

ROD DIAMETER (INCHES x LENGTH/(FT.))
5/8x8

THE POWER LINE HARDWARE GALVANIZED STANDARD GROUND ROD HAS A CORE OF AISI 1010-1029 HOT ROLLED CARBON STEEL. THE GROUND ROD IS CONE POINTED AND CHAMFERED ON THE END TO REDUCE "MUSHROOMING" DURING HAMMER DRIVEN INSTALLATION. HOT DIPPED GALVANIIZED GROUND ROD MUST MEET ASTM A 153 SPECIFICATIONS.

GROUND ROD

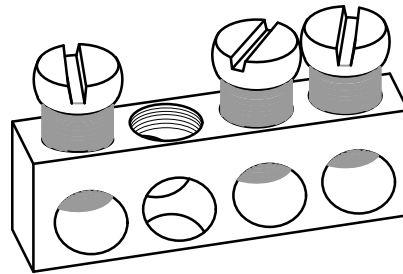

COMPLEMENTARY:

NUMBER OF CONNECTORS	3
AWG GAUGE	AWG 14...AWG 4 COPPER
PROVIDED EQUIPMENT	2 SCREW
BAR LENGTH	1.38 IN (35 MM)
DEVICE MOUNTING	DIRECT MOUNTING BACK OF ENCLOSURE
HEIGHT	0.437 IN (11.10 MM)
DEPTH	0.312 IN (7.92 MM)

LOADCENTRE GROUND BAR ASSEMBLY

NOTE:

1. ALUMINUM CONDUCTORS ARE NOT ALLOWED.

I:\CITYAPPS\AUTOCAD\STD_DETAILS\DRAWING_FILES\T21-18B.DWG



STREET LIGHT DISCONNECT GROUNDING

CITY OF VANCOUVER
 DEPARTMENT OF PUBLIC WORKS
 TRANSPORTATION DIVISION

DRAWN BY	APPROVED BY	APPROVAL DATE
CDC		2/21
REVISION	APPROVED BY	APPROVAL DATE
4		3/24

STD. PLAN NO.
T21-18B