

24"
NO
PARKING
 30"
 R8-3
 R/W

INSTALL ON TYPE 2 BARRICADES THROUGHOUT THE WORK AREA 24 HOURS PRIOR TO IMPLEMENTING TRAFFIC CONTROL. PRIOR NOTIFICATION OF LOCAL LAW ENFORCEMENT REQUIRED.

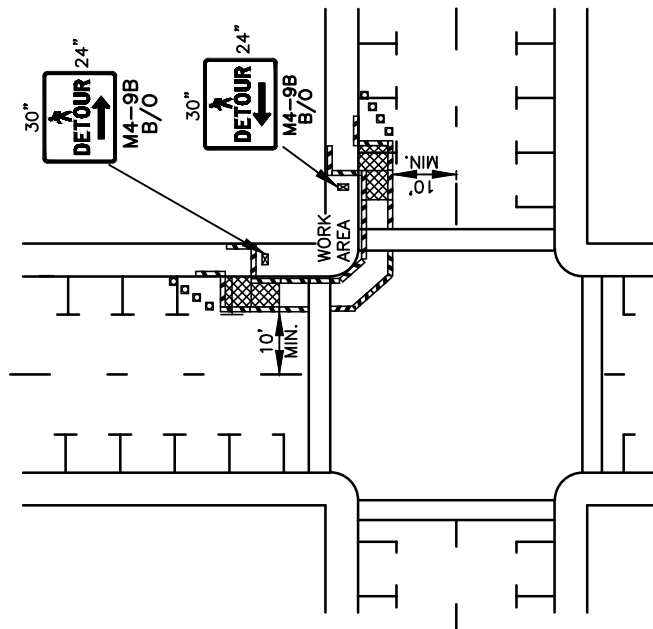

SIDEWALK DIVERSION

- LEGEND**
- ▣ TEMPORARY SIGN LOCATION
 - ▣ CHANNELIZING DEVICES
 - ▣ PEDESTRIAN CHANNELIZING DEVICES
 - ▣ TEMPORARY PEDESTRIAN RAMP FOR SIDEWALKS

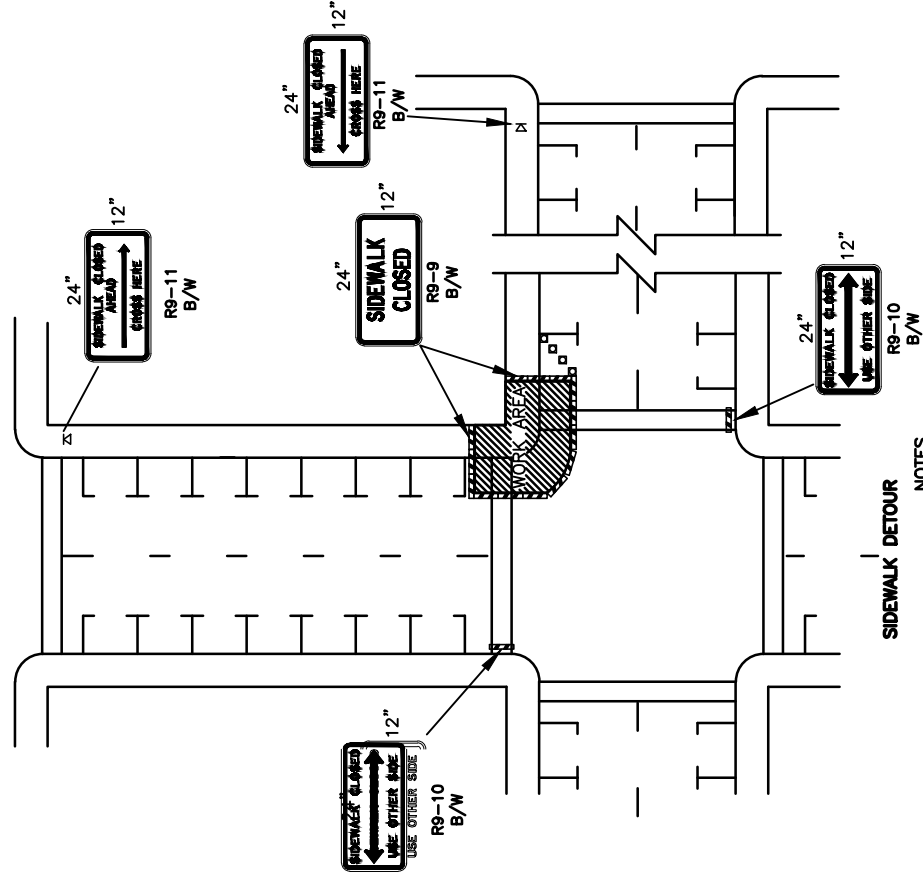

SIDEWALK DETOUR

NOTES

1. CONTROLS SHOWN ARE FOR PEDESTRIAN TRAFFIC ONLY.
2. A 60" PATH WIDTH SHOULD BE MAINTAINED (48" IS THE MINIMUM).
3. CONTACT AND COORDINATE IMPACTED TRANSIT AGENCIES PRIOR TO IMPLEMENTING ANY CLOSURES.
4. SEE SHEET TC-52 OR TC-53 FOR TEMPORARY PEDESTRIAN RAMP DETAILS.
5. ADA PEDESTRIAN FACILITIES MUST BE MAINTAINED. SEE STANDARD SPECIFICATION 1-10.2(1)B.
6. TEMPORARY PEDESTRIAN PUSH BUTTONS SHALL BE PLACED ON THE DIVERTED PATH WHEN EXISTING BUTTONS ARE NOT ACCESSIBLE TO PEDESTRIANS.

**TRAFFIC CONTROL STANDARD PLAN
 INTERSECTION PEDESTRIAN TRAFFIC CONTROL**

CITY OF VANCOUVER
 DEPARTMENT OF PUBLIC WORKS
 TRANSPORTATION DIVISION



APPROVED BY	APPROVAL DATE
CDC	9/21
REVISION	APPROVAL DATE
2	3/24

STD. PLAN NO.
TC16A