

BUFFER DATA

LONGITUDINAL BUFFER SPACE = B	25	30	35	40	45
SPEED (MPH)	155	200	250	305	360
LENGTH (FEET)	BUFFER VEHICLE ROLL AHEAD DISTANCE = R				
TRANSPORTABLE ATTENUATOR	30 FEET MIN. TO 100 FEET MAX.				
MINIMUM HOST VEHICLE WEIGHT SHALL BE IN ACCORDANCE WITH THE MANUFACTURERS RECOMMENDATION.					

PROTECTIVE VEHICLE MAY BE A WORK VEHICLE STRATEGICALLY LOCATED TO SHIELD THE WORK AREA.

NO SPECIFIED DISTANCE REQUIRED

SIGN SPACING = X (1)

PRINCIPAL ARTERIALS	45 MPH	500'±
PRINCIPAL, MINOR OR COLLECTOR ARTERIALS	35/40 MPH	350'±
PRINCIPAL, MINOR, COLLECTOR ARTERIALS, INDUSTRIAL AND LOCAL ACCESS ROADWAYS	25/30 MPH	200'± (2)
INDUSTRIAL AND LOCAL ACCESS ROADWAYS	25 MPH OR LESS	100'± (2)

(1) ALL SPACING MAY BE ADJUSTED TO ACCOMMODATE INTERSECTIONS AND DRIVEWAYS.
 (2) THIS SPACING MAY BE REDUCED IN URBAN AREAS TO FIT ROADWAY CONDITIONS.

CHANNELIZATION DEVICE SPACING (FEET)		
MPH	TAPER	TANGENT
35/45	30	60
25/30	20	40

(OPTIONAL IF 40 MPH OR LESS)

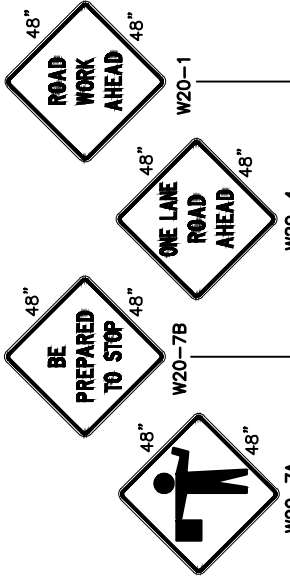

50' TO 100' 6 DEVICE MIN.

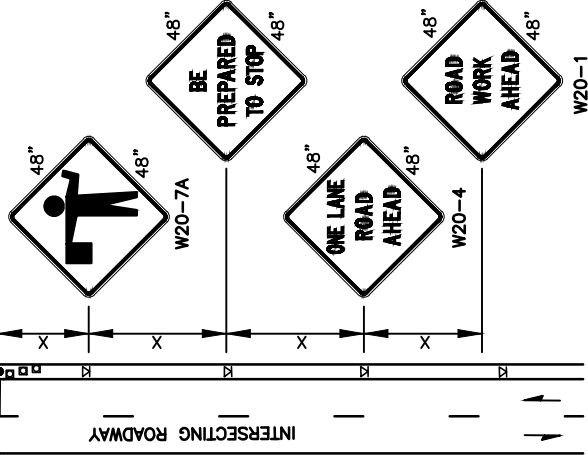
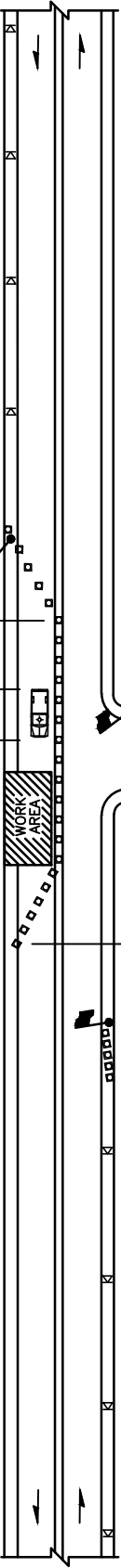

- NOTES:**
1. ALL SIGNS ARE BLACK ON ORANGE.
 2. EXTENDING THE CHANNELIZING DEVICE TAPER ACROSS SHOULDER IS RECOMMENDED.
 3. NIGHT WORK REQUIRES ADDITIONAL ROADWAY LIGHTING AT FLAGGING STATIONS. SEE THE STANDARD SPECIFICATIONS FOR ADDITIONAL DETAILS.
 4. SEE SPECIAL PROVISIONS FOR WORK HOUR RESTRICTIONS.

- LEGEND**
- ◀ FLAGGING STATION
 - ▣ TEMPORARY SIGN LOCATION
 - ▣ CHANNELIZING DEVICES
 - ▣ PROTECTIVE VEHICLE

CITY OF VANCOUVER
 DEPARTMENT OF PUBLIC WORKS
 TRANSPORTATION DIVISION

TRAFFIC CONTROL STANDARD PLAN
ONE-LANE TWO WAY TRAFFIC CONTROL WITH FLAGGERS

STD. PLAN NO. **TC1**

DRAWN BY	APPROVED BY	APPROVAL DATE
CDC		3/16
REVISION	APPROVED BY	APPROVAL DATE
3		3/24

